

D5003-S-MR16 SPOT LIGHT



APPLICATIONS

Area: Indoor use only.No dimmer.

Purpose: Accent lighting.Local lighting.

ADVANTAGES:

- *Adopting NICHIA's 183 series LEDs with high lumens and long lifetime.*
- *Pure aluminum shell adopted special surface treatment technology, dustproof and good heat elimination performance.*
- *Ceramic radiator perfects the performance of insulation and heat elimination.*
- *Special optical design achieves perfect light performance.*



Specification:

Model number		D5003-S-MR16(WW)	D5003-S-MR16(NW)
LED	Origin	NICHIA 183	NICHIA 183
	Lumens/Led	165-175	215-225
	Current	700mA	700mA
Color temperature		2800±200K/3200±200K	5000±200K
Power consumption		4W(1×3W)	4W(1×3W)
Beam Angle		30°	30°
Input voltage		12VDC/AC	12VDC/AC
Working temperature		-5℃~+35℃	-5℃~+35℃
Base type		MR16	MR16
Dimension		φ 50×50(L)mm	φ 50×50(L)mm
Net weight		50g	50g
Lifetime(hr)		40000	40000

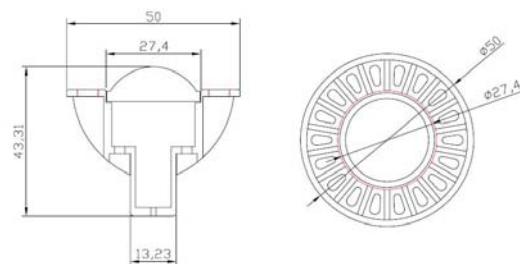

Packaging information:

Packing: 144 boxes / carton		
Box	52×52×70(mm)	66g
Carton	57.5×26.5×36(cm)	11.51kg

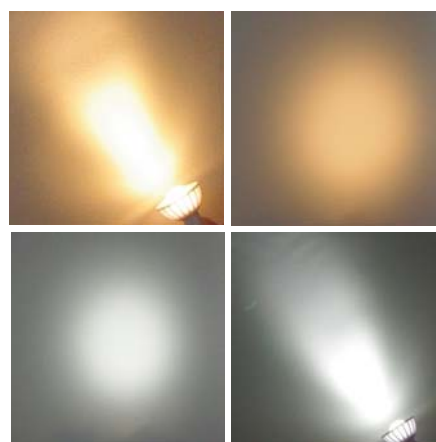

Optical Performance:

Model number	Beam Angle	Lumens	CRI
D5003-S-MR16(WW)	30 degree	100	80
D5003-S-MR16(NW)	30 degree	135	75

D5003-S-MR16(WW)

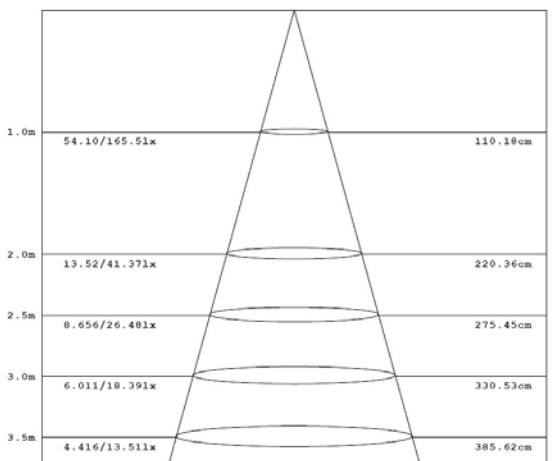
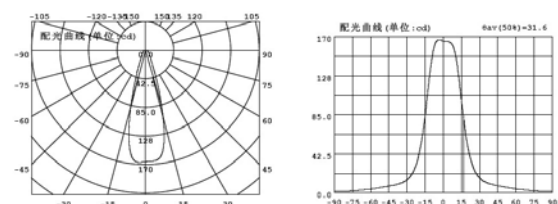

Height Lux Diameter

D5003-S-MR16(NW)

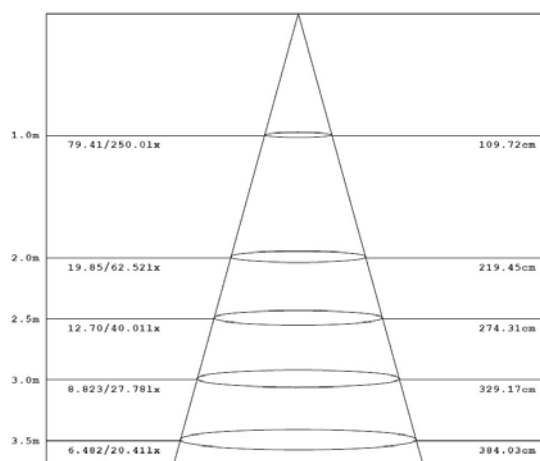
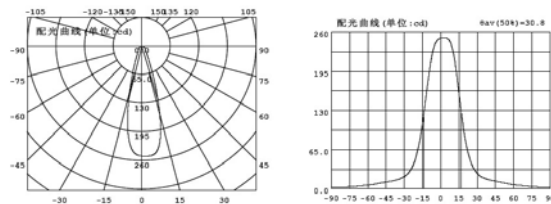

Height Lux Diameter



Important Caution

1. If you choose Electronic transformer, please make sure to select a good quality Electronic Transformer (simplified version is not acceptable), of which the output is 12VAC.
2. If you choose Electronic transformer, the transformer should be at least 40% load when working, or the LED lamp will not work normally (flicker, not bright enough or other conditions) since the output of the Electronic Transformer will be too low (below 8V).
3. Not suitable for high temperature and moisture area.
4. Not suitable for heavy air-polluted area.
5. Not suitable for close system fixture.